

DESCRIPTION

- SMD LED technology for indoor installation.
- Principally used in operating theatres.
- Hours, minutes and seconds display.
- Fixed or alternate time with date or week number display or timer display.
- Height of digits 5 cm, optimal viewing distance: 20 metres.
- Angle of vision: 120°.
- LED colours: red or green.
- Models: independent, impulse, AFNOR and NTP.



STANDARDS

- EMC: - EN55032.
- EN55024.
- LVD: EN60950.
- R&TTE (radio models): EN301-489-3.

TECHNICAL FEATURES OF THE CLOCK

GENERAL

- **Adjustable brightness**..... 4 levels.
- **Display mode**..... 12 or 24 hour.
- **Eco mode**..... Programmable energy saving or predefined over a time period.
- **Time change**..... Automatic summer/winter time changeover and perpetual calendar.
- **Time base backup**.....
 - Independent model: 15 days in case of power failure.
 - Impulse model: in case of power failure, data saving and impulses reception without battery.
 - Synchronised models: at each start the clocks wait for the synchronisation signal.
- **Time accuracy**..... 0.2 second/day (except NTP model: precision dependent on the time server).
- **Operation**..... Silent.
- **Digit**..... 7 segments with 3 LEDs each.
- **Hours and minutes separating**..... Colon made of LEDs.
- **Configuration**..... 2 capacitive buttons.
- **NTP model**.....
 - Synchronisation unicast, multicast and by DHCP.
 - Advanced configuration from the embedded web server.

See the product page
>> www.bodet-time.com <<



MECHANICAL

- **Construction**..... Stainless steel casing (IP54, IK03) and PPMA Poly (methyl methacrylate) cristal.
- **Mounting**..... Flush mounting with 4 holes (screws not provided).
- **Operating temperature range**..... -5 to +55°C.
- **Weight**..... 1.2 Kg.
- **Dimensions**..... 412 x 122 x 45.19 mm (see on the back).

ELECTRICAL

- **Power supply**.....
 - Independent, impulse and AFNOR models: 100-240VAC.
 - NTP model: PoE (Power over Ethernet) – class 0.
- **Consumption max**..... 4.5 W.
- **Electric protection (except NTP model)**..... Class 2.

STYLE 5S OP REFERENCES (BY SYNCHRONISATION)



Red

946 311
946 321
946 351
946 371



Green

946 312 Independent model
946 322 Impulse model
946 352 AFNOR model
946 372 NTP model

946 012 Back cover for recess mounting

Add a «K» at the end of the reference to include the control unit.
Ex.: 946 311K => Style 5S OP Independent with control unit – red LED



STYLE 55 OP

Clock dimensions in mm:

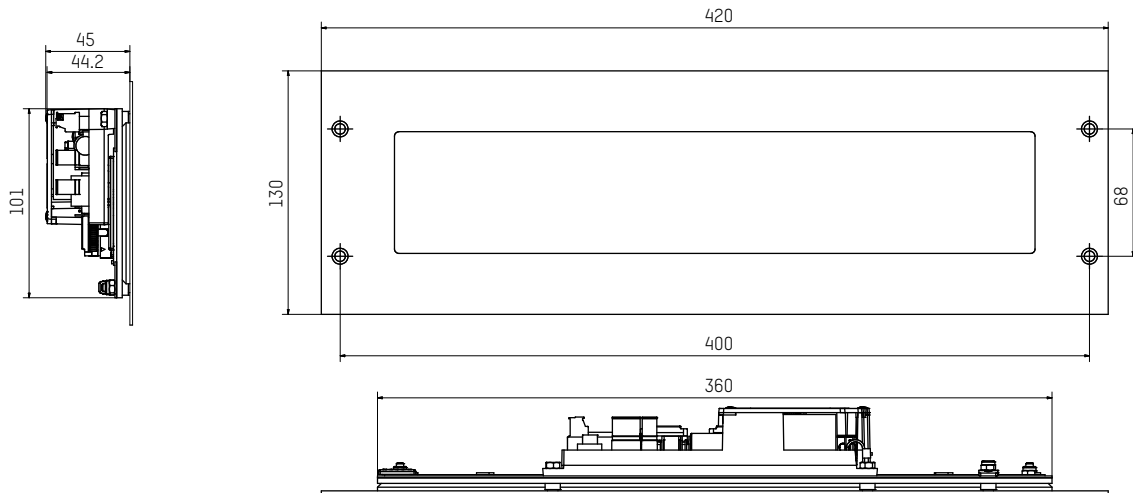

Recess mounting dimensions in mm:

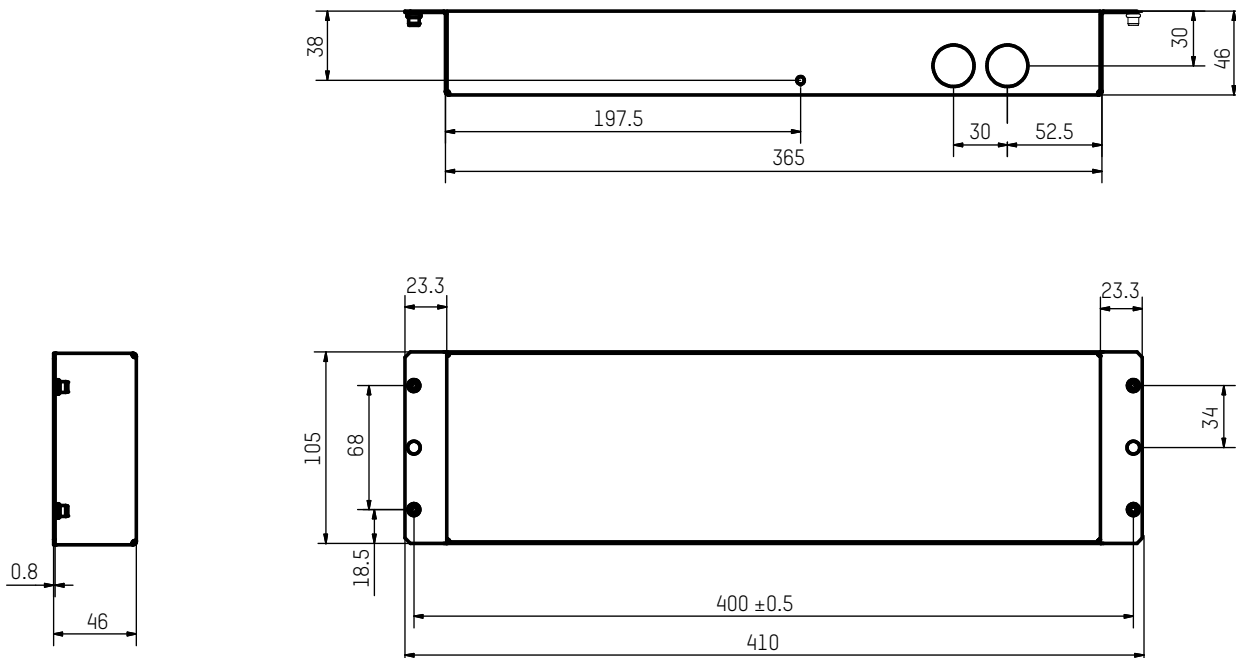

Flush mounting dimensions in mm:

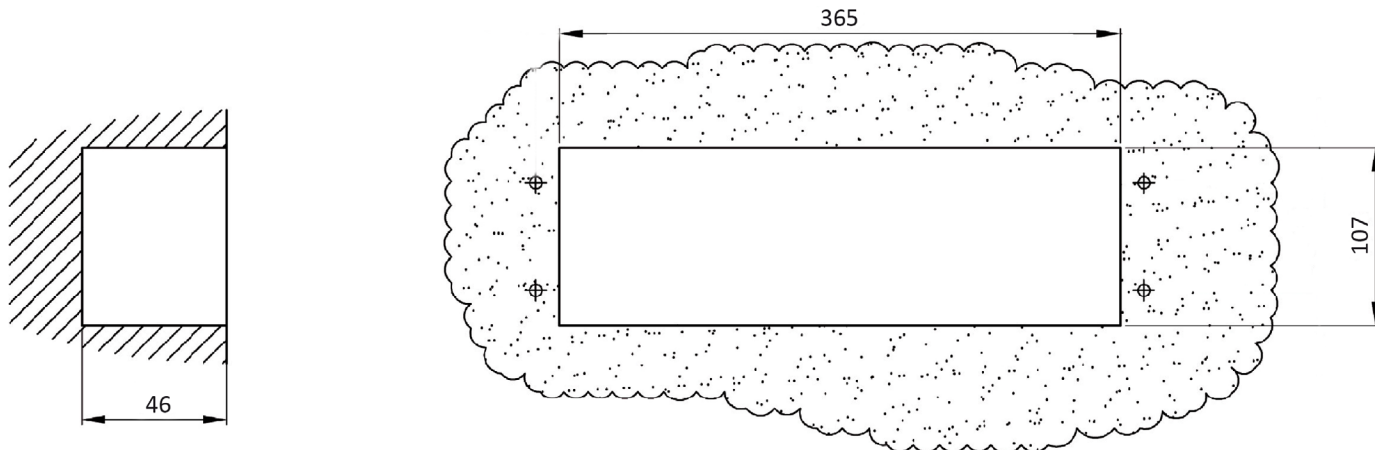

TECHNICAL FEATURES OF THE CONTROL UNIT

GENERAL

- **Stopwatch**..... Hour - minute - second from 0 to 23:59:59.
- **Control unit**..... Waterproof control unit with touch sensitive keys for easy cleaning:
 - Time display mode key with LED indicator.
 - Stopwatch display mode key with LED indicator.
 - Start/stop key: successive pressings for start/stop of the stopwatch.
 - Reset key: resetting to zero of the stopwatch.
- **Control**..... Up to 10 clocks.

MECHANICAL

- **Binding**..... Flush mounting (screws not provided).
- **Operating temperature**..... 0 to 50°C.
- **Protection index**..... The front face IP 55.
- **Weight**..... 255 g.

ELECTRICAL

- **Connection**..... 2-pair telephone cable 0.5 mm. Max length: 20 meters.
- **Power supply**..... Power by the clock.



Control unit dimensions in mm:

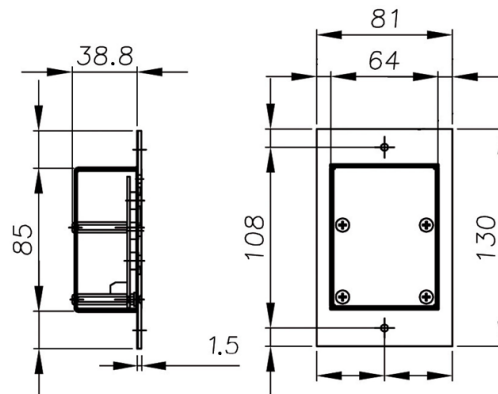

Flush mounting dimensions in mm:

